

SUBMITTAL SHEET

| | |
|-------------------|-------------|
| JOB NAME | ITEM TAG |
| JOB LOCATION | PART NUMBER |
| CONTRACTOR | DATE |
| ENGINEER APPROVAL | DATE |

LEAD-FREE CPVC TRANSITION FITTINGS

CPVC No-Lead Transition Fittings x PEX

Permits for a simple transition between PEX piping and CPVC tubing.

Ideal for all residential, commercial and industrial hot and cold water systems.

Eliminates the need for multiple adapters and subsequently, their additional leak-paths and run length.

Available in nominal sizes 1/2" to 1" solvent-weld tubing socket by PEX; F1807 and F1960.

Working Pressure, Non Shock (PSI)

Cold working pressure (CWP): 100 psi, up to 180° F

Saturated steam (WSP): Not suitable for steam service



Pictured:
CPVC x F1807



Pictured:
CPVC x F1960

| MATERIAL SPECIFICATION | | | |
|------------------------|------------------------------------|------------------------|------------------------|
| PART | MATERIAL | SPECIFICATION | |
| 1 | Solvent-weld socket tubing adapter | Virgin PVC resin | ASTM D1784 Class 23447 |
| 2 | O-ring | EPDM rubber | Commercial grade |
| 3 | Pipe thread adapter | Lead-free forged brass | UNS Alloy C46400 |

| DIMENSIONS (F1960) - Inch | | | |
|---------------------------|------|------|--|
| Size | A | B | |
| 1/2" F1960 x CPVC | 0.99 | 1.91 | |
| 3/4" F1960 x CPVC | 1.22 | 2.34 | |
| 1" F1960 x CPVC | 1.44 | 2.90 | |

| DIMENSIONS (F1807) - Inch | | | |
|---------------------------|------|------|--|
| Size | A | B | |
| 1/2" F1807 x CPVC | 0.99 | 1.91 | |
| 3/4" F1807 x CPVC | 1.22 | 2.30 | |
| 1" F1807 x CPVC | 1.38 | 2.80 | |

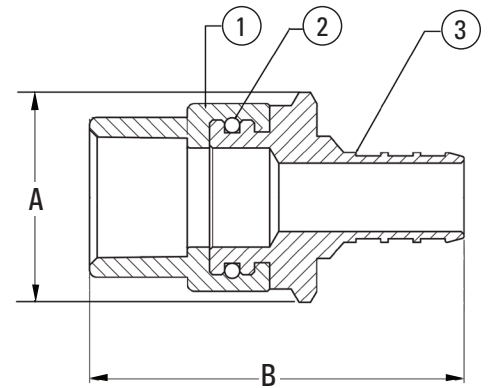

Pictured:
F1807 x CPVC
Cut-away

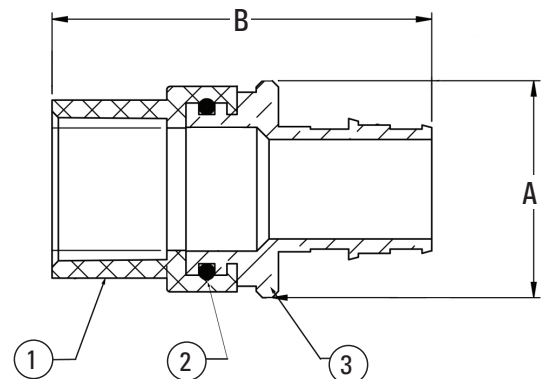

Pictured:
F1960 x CPVC
Cut-away

Certifications/Listings:

Third-party certified.

NSF/ANSI 14: Plastic piping system components and related materials.

Standards:

ASTM D1784: Standard specification for rigid PVC and CPVC compounds

ASTM D2846: Standard specification for PVC and CPVC plastic hot- and cold-water distribution systems

ASTM F1807: Metal insert fittings utilizing a copper crimp ring or stainless steel clamps

ASTM F1960: Cold expansion fittings with PEX reinforcing rings.